

ULE21VW Series



ULE21VW Series

The OptoElectronix[™] ULE21VW module is a complete LED lighting solution that integrates an LED light source, lens, driver, and thermal management in a compact, easy-to-use single package. This high-output recessed lamp connects directly to a 12V AC or DC power source. It is available in warm, neutral, or cool white.

Features

- Sealed Construction
- UL & NSF Approved
- Water-resistant
- Wide Beam Angle
- No filaments, vibration proof

Key Applications

The ULE21VW light engine, with a 120-degree beam angle, has proven to be a highly versatile light source suitable for use in commercial-grade refrigerators and freezers, range hoods, retail display lighting, vending machines, dome lights, vanity lights, emergency exit lights, vent fans and low-wattage MR16 replacements.

Thermal Management

The ULE21VW includes a unique housing that efficiently removes heat from the LED. Mounting the light engine to metal according to specifications completes the thermal network. The result is a highly reliable, long-life LED lighting solution that fits a variety of end applications.

Certifications and Completed Tests

Underwriters Laboratories: UL Component Recognition program for the U.S. and Canada under UL File No. E323412.

RoHS: Compliant

NSF International: NSF/ANSI 2 compliant – safe to use in fabricated food equipment (refrigerators, range hoods, etc.) under NSF certificate C0031880-01

Ingress Protection Rating: IP66 – dust tight and protected against powerful water jets.

IESNA LM80-08: LEDs used comply with LM80-08 standards ensuring life-span.

Mechanicals

[inches]

mm

input wires are non-polarized

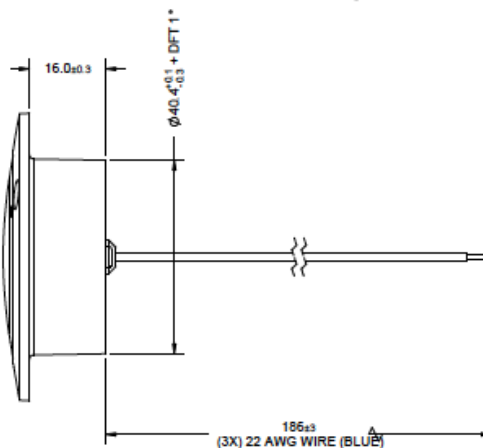
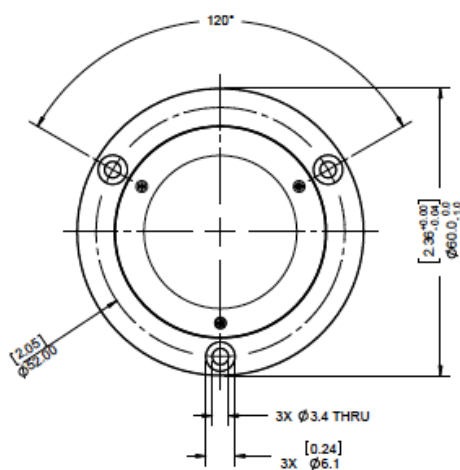

Product Specifications
Warm White Models

ULE21VW0C-F-25W	Unit	Typical
Input Voltage	volts	12
Total Power	watts	2.2
Luminous Flux	lumens	120
Color Temperature	°K	3000
CRI		85
Beam Angle	degrees	120

ULE21VW0C-F-38W	Unit	Typical
Input Voltage	volts	12
Total Power	watts	4.3
Luminous Flux	lumens	240
Color Temperature	°K	3000
CRI		85
Beam Angle	degrees	120

ULE21VW0C-F-45W	Unit	Typical
Input Voltage	volts	12
Total Power	watts	6.5
Luminous Flux	lumens	360
Color Temperature	°K	3000
CRI		85
Beam Angle	degrees	120

ULE21VW0C-F-45W HO K30C80L450	Unit	Typical
Input Voltage	volts	12
Total Power	watts	6.5
Luminous Flux	lumens	450
Color Temperature	°K	3000
CRI		85
Beam Angle	degrees	120

Neutral White Models

ULE21VW1C-F-25W K40C80L120	Units	Typical
Input Voltage	volts	12
Total Power	watts	2.2
Luminous Flux	lumens	120
Color Temperature	°K	4000
CRI		85
Beam Angle	degrees	120

ULE21VW1C-F-38W K40C80L240	Units	Typical
Input Voltage	volts	12
Total Power	watts	4.3
Luminous Flux	lumens	240
Color Temperature	°K	4000
CRI		85
Beam Angle	degrees	120

ULE21VW1C-F-45W K40C80L360	Units	Typical
Input Voltage	volts	12
Total Power	watts	6.5
Luminous Flux	lumens	360
Color Temperature	°K	4000
CRI		85
Beam Angle	degrees	120

ULE21VW1C-F-45W HO K40C60L500	Unit	Typical
Input Voltage	volts	12
Total Power	watts	6.5
Luminous Flux	lumens	500
Color Temperature	°K	4000
CRI		65
Beam Angle	degrees	120

Cool White Models

ULE21VW1C-F-25W	Unit	Typical
Input Voltage	volts	12
Total Power	watts	2.2
Luminous Flux	lumens	130
Color Temperature	°K	6500
CRI		85
Beam Angle	degrees	120

ULE21VW1C-F-38W	Unit	Typical
Input Voltage	volts	12
Total Power	watts	4.3
Luminous Flux	lumens	260
Color Temperature	°K	6500
CRI		85
Beam Angle	degrees	120

ULE21VW1C-F-45W	Unit	Typical
Input Voltage	volts	12
Total Power	watts	6.5
Luminous Flux	lumens	390
Color Temperature	°K	6500
CRI		85
Beam Angle	degrees	120

ULE21VW1C-F-45W HO K65C60L500	Unit	Typical
Input Voltage	volts	12
Total Power	watts	6.5
Luminous Flux	lumens	500
Color Temperature	°K	6500
CRI		65
Beam Angle	degrees	120

Typical Environmental Specifications	
Operating Temperature	-20°C to 50°C
Thermal Management	Extended Heat-sink required
Lumens Maintenance at L70*	>50,000 hours

*Warranty for 35,000 hours or 5 years, whichever comes first.